

Dubai Creek Harbour

# CREEK BEACH

---

ORCHID

EMAAR

# THE WORLD OF TOMORROW

Dubai Creek Harbour is an ultra-modern and stylish neighbourhood situated along the historic Dubai Creek.

Designed with pedestrian-friendly streets, Dubai Creek Harbour offers convenient connections between the neighbourhood centre and a viable mix of retail, business, recreation, parks, open spaces, and community facilities, all within walking distance.



10 Mins from  
Burj Khalifa



15 Mins from  
Dubai Int'l Airport



Wildlife Sanctuary  
Home of Pink Flamingos



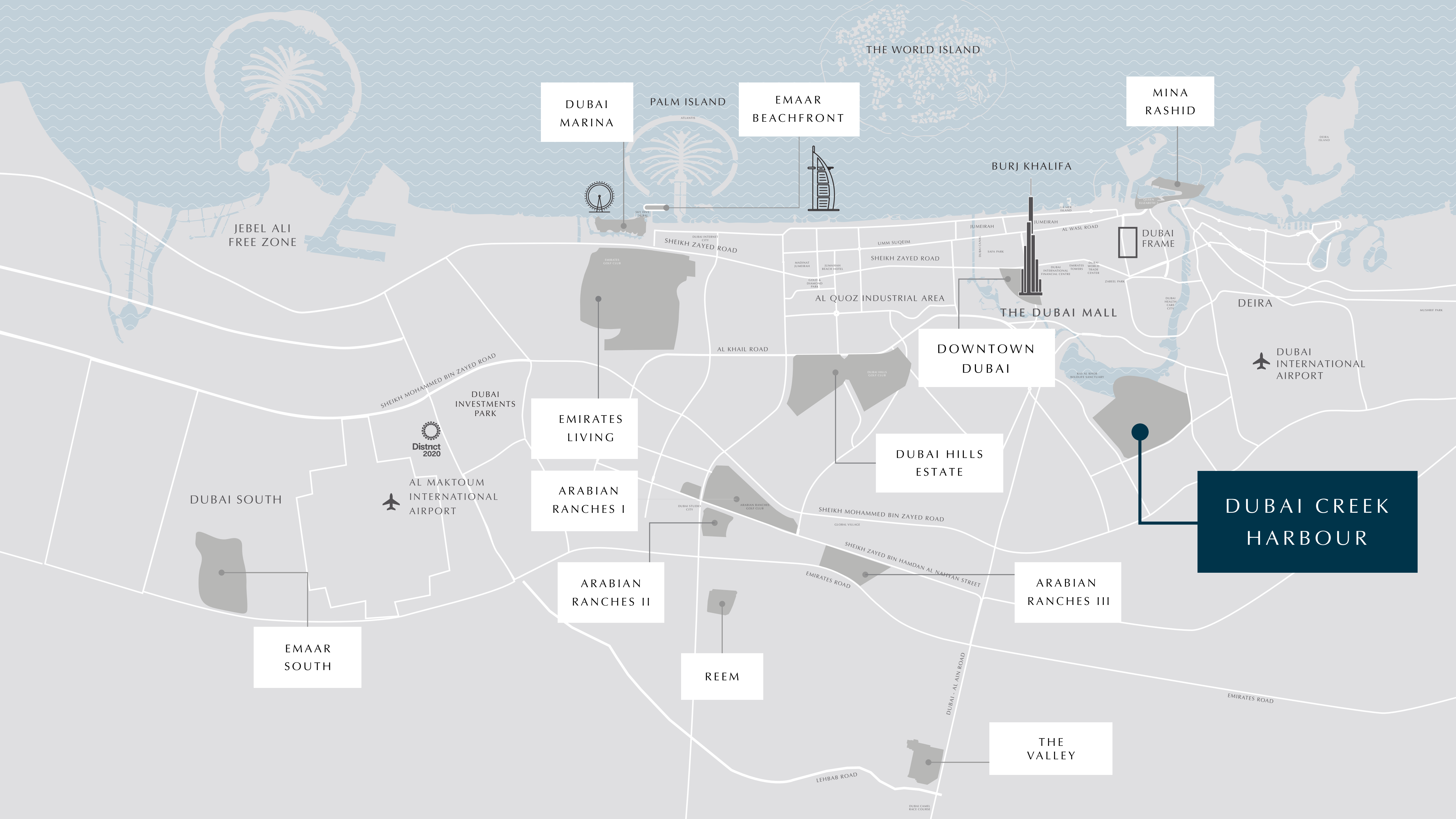

DUBAI MARINA

PALM ISLAND

EMAAR BEACHFRONT

THE WORLD ISLAND

MINA RASHID

JEBEL ALI FREE ZONE

BURJ KHALIFA

DUBAI FRAME

SHEIKH ZAYED ROAD

UMM SUQEIM

SHEIKH ZAYED ROAD

JUMEIRAH

JUMEIRAH

AL WASH ROAD

DEIRA

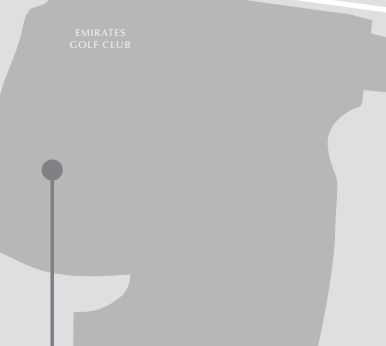

MADINAT JUMEIRAH

JUMEIRAH BEACH HOTEL

GOLD & DIAMOND PARK

THE DUBAI MALL

DUBAI INTERNATIONAL AIRPORT

DOWNTOWN DUBAI

AL KHAIL ROAD

EMIRATES LIVING

DUBAI HILLS ESTATE

SHEIKH MOHAMMED BIN ZAYED ROAD

DUBAI INVESTMENTS PARK



AL MAKTOUM INTERNATIONAL AIRPORT

ARABIAN RANCHES I

DUBAI CREEK HARBOUR

DUBAI SOUTH

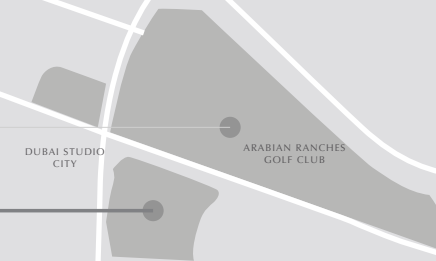

SHEIKH MOHAMMED BIN ZAYED ROAD

ARABIAN RANCHES II

ARABIAN RANCHES III

EMAAR SOUTH

GLOBAL VILLAGE

SHEIKH ZAYED BIN HAMDAN AL NAHYAN STREET

REEM

THE VALLEY

EMIRATES ROAD

DUBAI - AL AIN ROAD

LEHBAB ROAD

EMIRATES ROAD

DUBAI CAMEL RACE COURSE

# CREEK BEACH

Creek Beach is Dubai's first-of-its-kind urban beach in the middle of Dubai Creek Harbour. Located along the historic Dubai Creek, Creek Beach is conceived to afford you the ultimate family-friendly retreat. From 700 metres of pristine white sands to the infinity pool and spectacular sunset views, this is paradise reborn.



Breathtaking  
Sunset Views



Creek Marina  
Yacht Club



World-Class  
Dining & Shopping  
Destinations



Socialise At  
Creek Promenade



Vibrant  
Inner Plaza

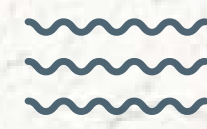

Proximity to  
a 700-Metre Beach

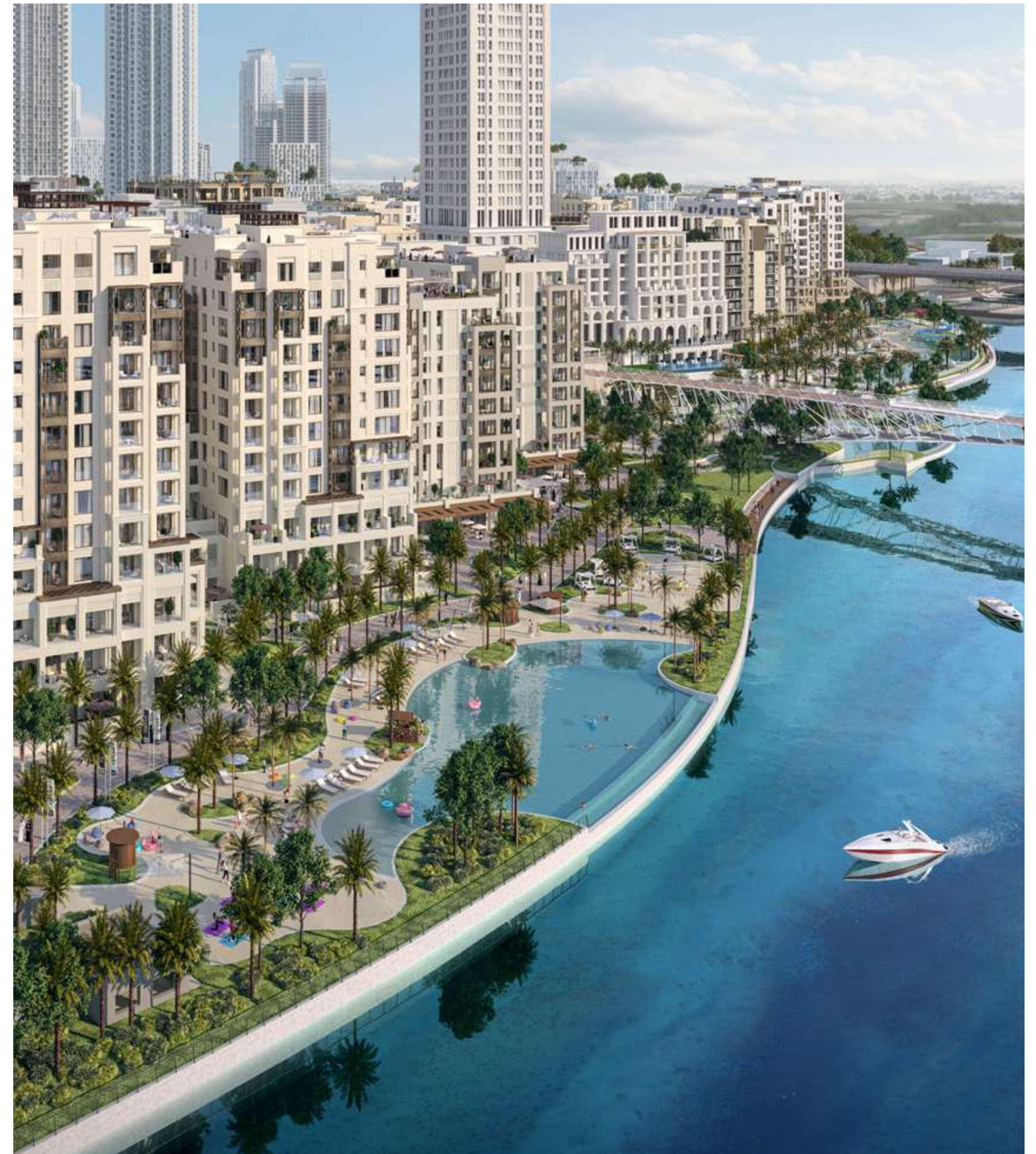



Dubai Creek Harbour

# ORCHID AT CREEK BEACH

Your Idyllic Creekside Life Awaits

Nestled in the heart of a family-focused community, Orchid comprises exquisitely designed apartments and sophisticated penthouses.

Situated just footsteps from Creek Beach, Orchid offers residents the very best of relaxed creekside living, along with a vibrant array of shopping, dining and family-friendly leisure experiences on the doorstep.



# EXACTLY WHERE YOU'RE MEANT TO BE

Perfectly positioned at the heart of a vibrant, family-focused community, Orchid boasts a wide array of dining, retail, leisure, and recreational amenities on the doorstep.



X Minutes walk to Creek Beach



X Minutes walk to Creek Promenade



X Minutes walk to Vida Creek Harbour

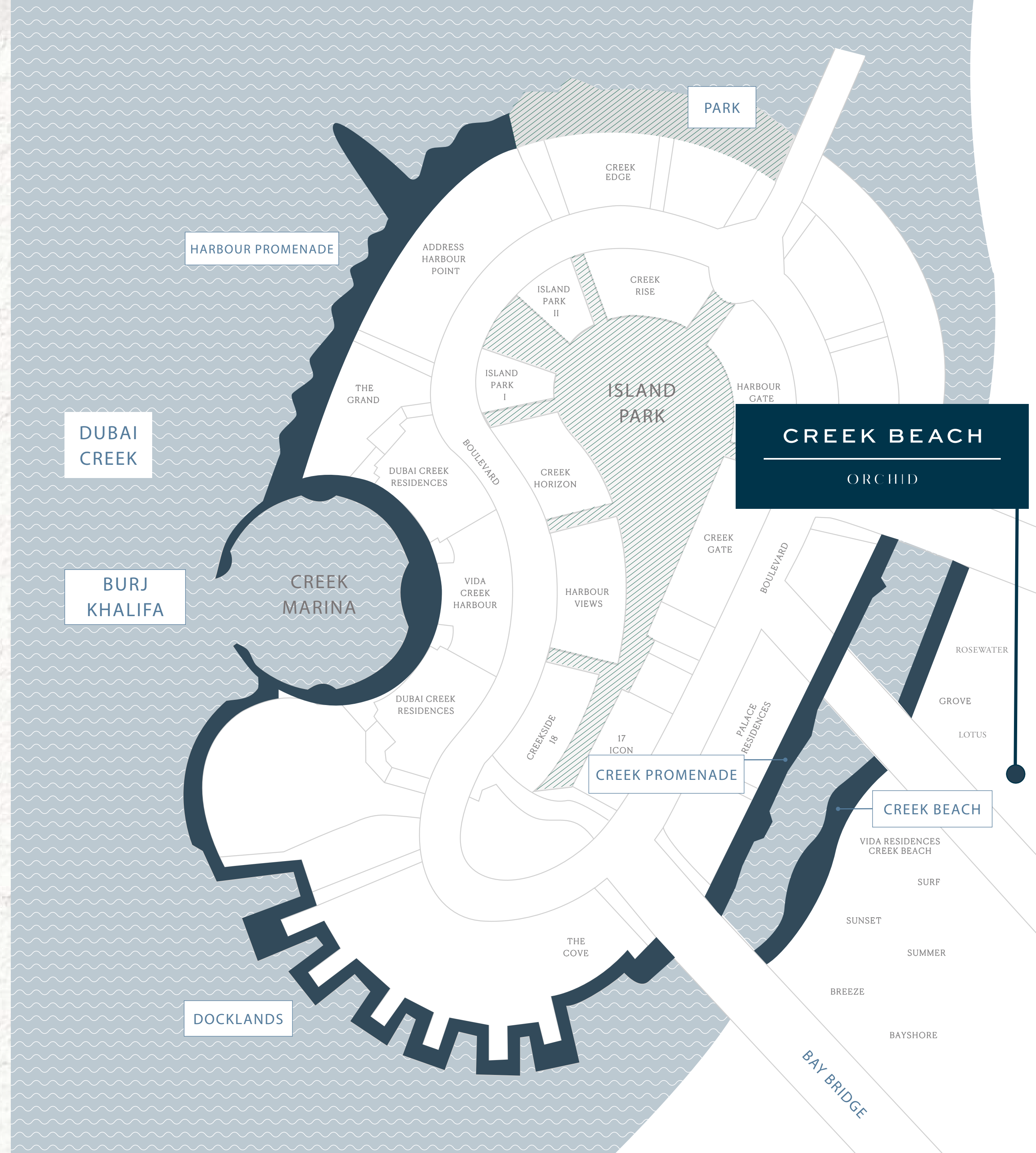



## LIVE LIFE TO THE FULL

Orchid's inspired array of apartments and penthouses perfectly blend luxury, comfort and tranquillity.

Each beautifully designed home is an urban residential haven where families can enjoy a truly fulfilling lifestyle amidst a thriving community.



Orchid at Creek Beach

# FEEL TRULY AT HOME

Positioned at the centre of a vibrant recreational hub,

Orchid is where you and your family can feel truly at home  
- immersed in a lifestyle of convenience and contentment,  
with everything you need just moments away.

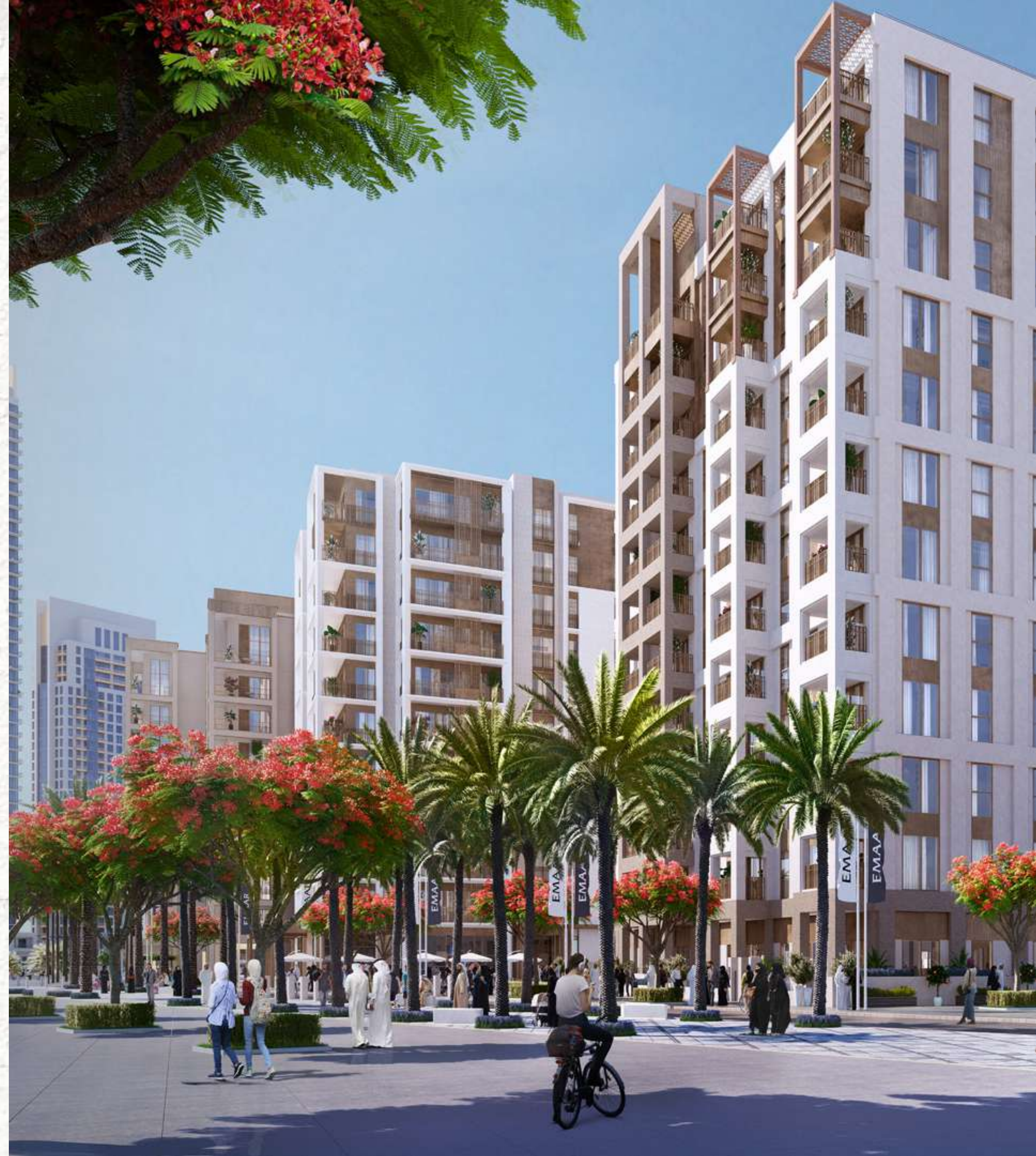





## DESIGNED FOR YOUR LIFESTYLE

Orchid's exquisite living spaces combine sophisticated yet simplistic design aesthetics with tasteful architectural touches, ensuring each residence strikes the perfect balance between elegance, comfort and practicality.

Interiors

# STYLISH LIVING SPACES FOR MODERN LIFESTYLES

Modern and refined 1, 2 & 3-bedroom apartments and  
sophisticated 4-bedroom penthouses.







# STRIKE THE RIGHT BALANCE, EVERY DAY

With family-friendly amenities, outstanding dining experiences, and shopping destinations on the doorstep, Orchid offers residents everything they need for a perfectly balanced lifestyle.



Community Pool  
& Kids Pool\*



Barbecue  
Facilities



Fully Equipped  
Gym



Multi-Purpose  
Room



Town  
Centre



Outdoor  
Play Area

# CREEK PROMENADE

Relax, unwind and enjoy quality time with family and friends as you dine and socialise at Dubai's newest hotspot.



Vibrant Waterfront  
Destination



Licensed Bars &  
Restaurants



Gourmet Dining  
Options



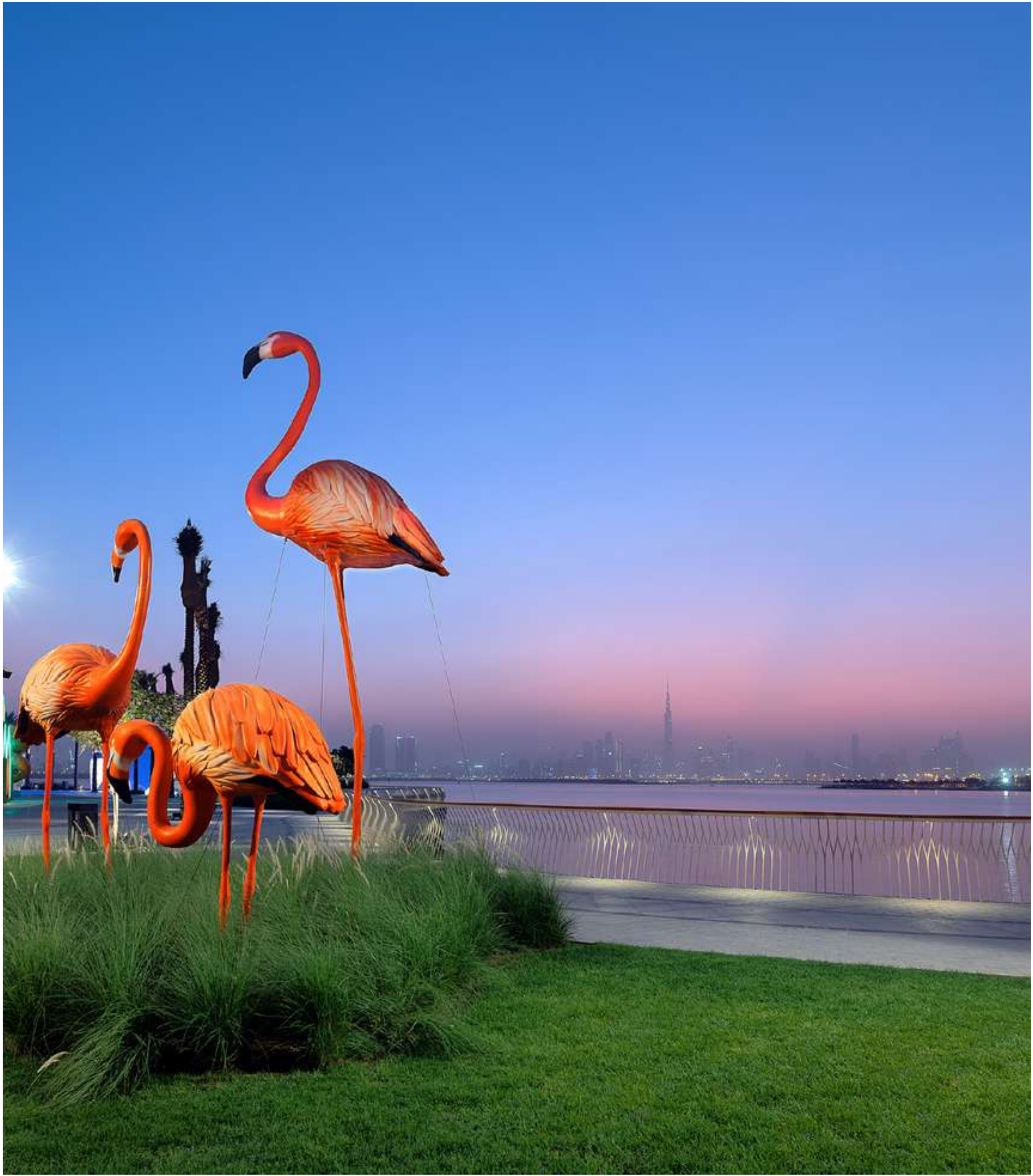

Nearby Attractions

# CREEK MARINA

Find the perfect balance between urban life and waterfront tranquility at Creek Marina.



Creek Marina  
Yacht Club



Interactive Art  
Installations



Near Central  
Park



Gourmet Dining  
Options



Waterfront  
Promenade



Wi-Fi  
Hotspots



# CENTRAL PARK

Central Park is the focal point of future-ready island living. Surrounded by Creek Island's breath-taking, contemporary, residential buildings – Central Park offers residents a tranquil retreat for relaxation, world-class amenities for enjoyment, and wide-open spaces for boundless recreation.



Verdant Open Spaces



Interactive Water Feature



Amphitheatre



Picturesque Desert Garden



Kids' Playground



Fitness Plaza & Skate Park



# GLOBAL LIFESTYLE DEVELOPER

An undisputed leader in the global real estate market, Emaar has grown over the years to become the largest real estate developer outside of mainland China. You will be investing with one of the most respected brands in the world.

NET PROFIT	REVENUE	MARKET CAP
AED	AED	AED
3.8BN	28.27BN	40BN

AS OF 31 DECEMBER 2021

RESIDENTIAL UNITS DELIVERED	RESIDENTIAL UNITS UNDER DEVELOPMENT
81,600+	35,200+



# CONTACT US

For more information on ORCHID in DUBAI CREEK HARBOUR,  
please call 800 36227 (UAE) / +971 4 366 1688 (International)  
or talk to our Property Advisor directly at +971 4888 8844 from 9 AM to 7 PM (GST), Monday to Friday.  
Visit our online sales centre at [emaar.com](http://emaar.com) or any of our Sales Centres across the UAE.

## DUBAI

Emaar Sales Centre | Downtown Dubai

9:30 AM to 10:00 PM, Sunday - Friday | From 9:30 AM to 7:00 PM, Saturday

Dubai Hills Estate Sales Pavilion | Umm Suqeim Road

Dubai Creek Harbour Sales Pavilion | Ras Al Khor

9:30 AM to 7:00 PM, Sunday - Saturday

## ABU DHABI

Emaar Sales Centre | Al Nahda Tower, Ground Floor, 4th Street, Corniche, Al Muroor Road

9:30 AM to 7:00 PM, Sunday - Friday | Closed, Saturday

# EMAAR